

SMD Power Inductor CDH38D09

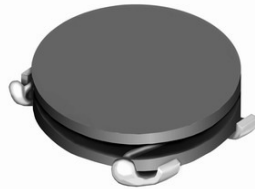

Halogen Free



Description

- Ferrite drum core construction.
- Magnetically unshielded.
- L × W × H: 4.0 × 4.0 × 1.0mm Max.
- Product weight: 42mg(Ref.)
- Moisture Sensitivity Level: 1
- RoHS compliance.
- Halogen Free available.

Dimension - [mm]

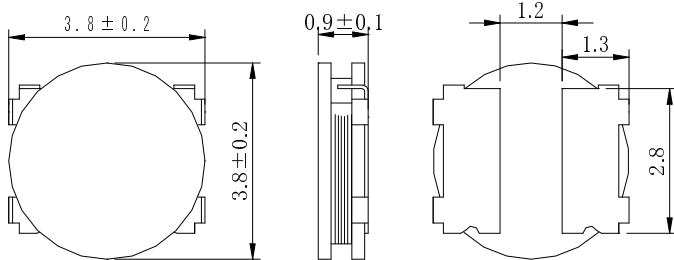

Land pattern and Schematics - [mm]

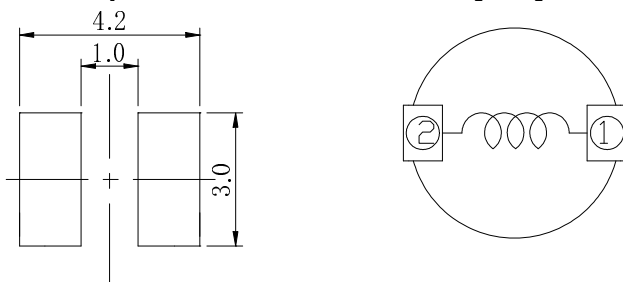

Environmental Data

- Operating temperature range: -40°C ~ +105°C (including coil's self temperature rise)
- Storage temperature range: -40°C ~ +105°C
- Solder reflow temperature: 260 °C peak.

Packaging

- Carrier tape and reel packaging.
- 7.0" diameter reel
- 1000pcs per reel

Applications

- Ideally used in Mobilephone, PDA, MP3, DSC/ DVC, HDD etc as DC-DC converter inductors.

Electrical Characteristics

Part Name	Stamp	Inductance (μ H) [within] ※1	D.C.R.(Ω) Max. (Typ.) (at 20°C)	Saturation Current (A) ※2		Temperature Rise Current (A) ※3
				at 20°C	at 105°C	
CDH38D09NP-1R2MC	1R2	1.2 ± 20%	0.14(0.11)	1.90	1.60	1.35
CDH38D09NP-1R5MC	1R5	1.5 ± 20%	0.16(0.13)	1.70	1.40	1.25
CDH38D09NP-2R2MC	2R2	2.2 ± 20%	0.19(0.15)	1.50	1.25	1.15
CDH38D09NP-2R7MC	2R7	2.7 ± 20%	0.21(0.17)	1.35	1.15	1.10
CDH38D09NP-3R3MC	3R3	3.3 ± 20%	0.24(0.19)	1.25	1.00	1.00
CDH38D09NP-4R7MC	4R7	4.7 ± 20%	0.30(0.24)	1.10	0.85	0.95
CDH38D09NP-6R8MC	6R8	6.8 ± 20%	0.39(0.31)	0.90	0.72	0.85
CDH38D09NP-8R2MC	8R2	8.2 ± 20%	0.50(0.40)	0.80	0.65	0.75
CDH38D09NP-100MC	100	10.0 ± 20%	0.58(0.47)	0.7	0.60	0.70
CDH38D09NP-150MC	150	15.0 ± 20%	0.87(0.69)	0.60	0.50	0.55
CDH38D09NP-220MC	220	22.0 ± 20%	1.14(0.91)	0.50	0.40	0.45

※1. Inductance measuring condition: at 100kHz.

※2. Saturation current: The value of D.C. current when the inductance decreases to 65% of it's nominal value.

※3. Temperature rise current: The value of D.C. current when the temperature rise is $\Delta t = 40^\circ\text{C}$ ($T_a = 20^\circ\text{C}$).

SMD Power Inductor CDH38D09



Saturation Current & Temperature Rise Graph

— L (20°C) — L (105°C) — ΔT

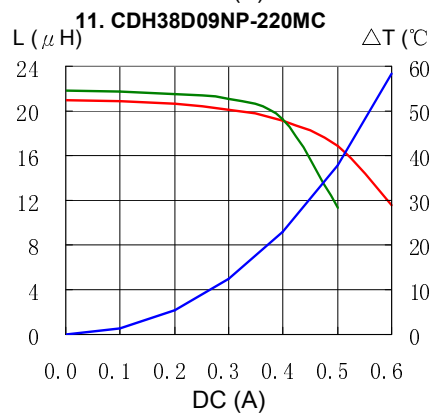
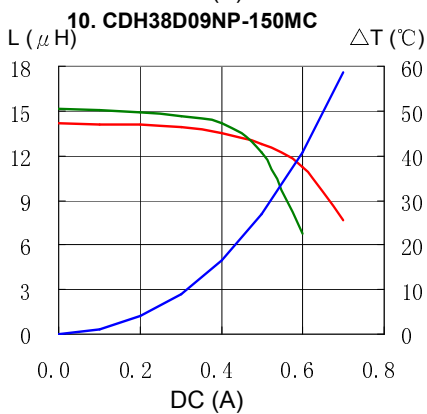
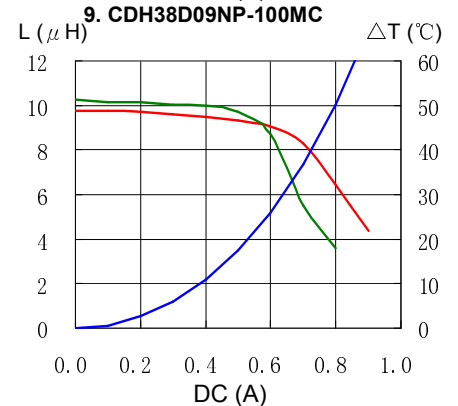
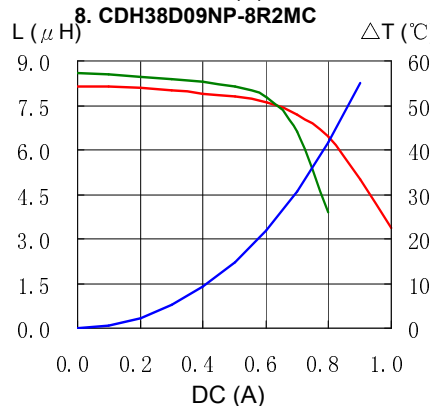
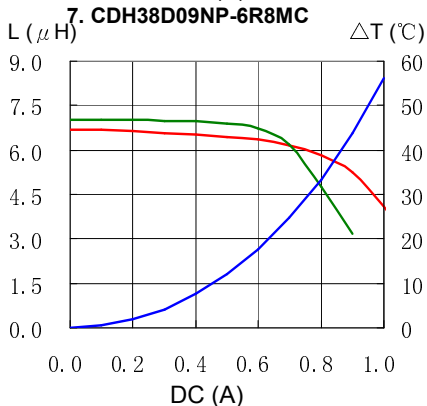
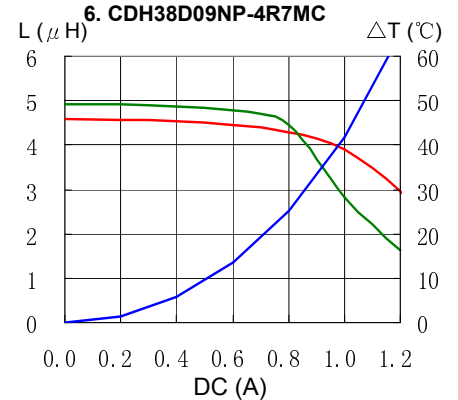
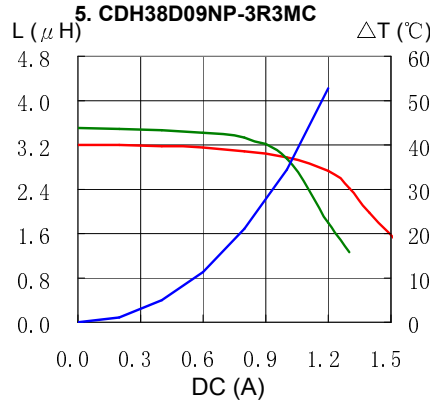
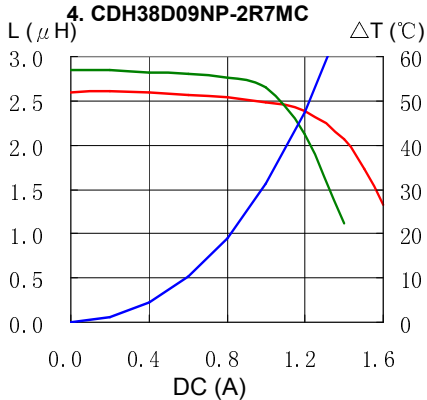
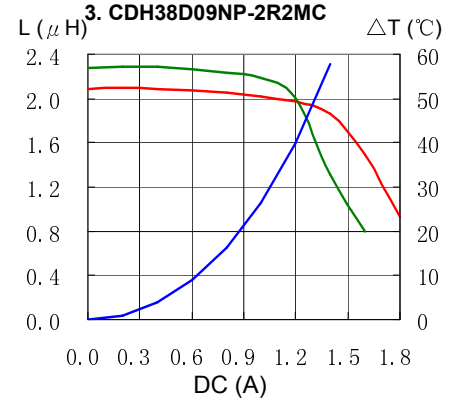
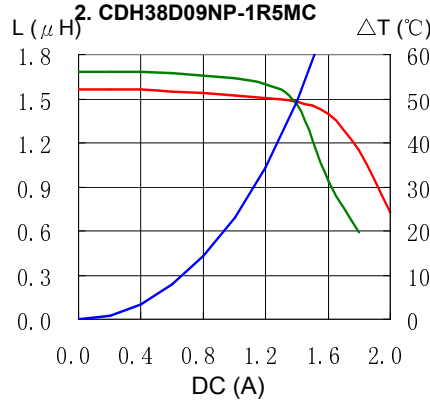
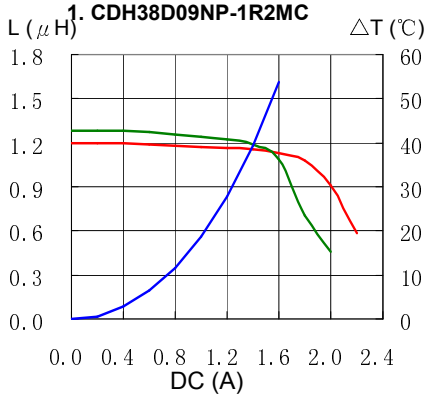

SMD Power Inductor CDH38D09



Solder Reflow Condition

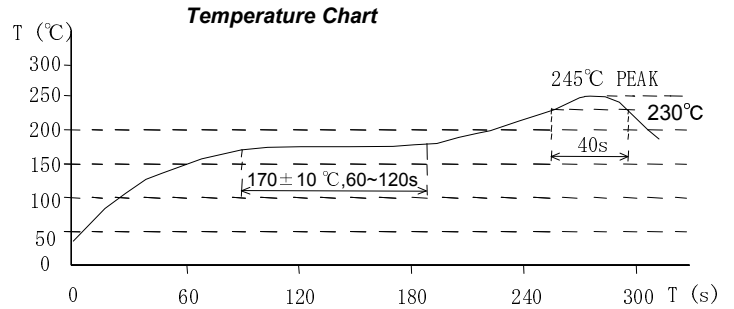
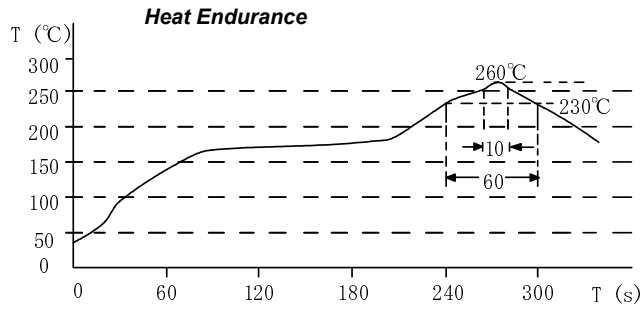

Please refer to the sales offices on our website - <http://www.sumida.com>

Hong Kong

Tel.+852-2880-6688
FAX.+852-2565-9600
sales@hk.sumida.com

Tokyo

Tel.+81-3-5202-7112
FAX.+81-3-5202-7105
sales@jp.sumida.com

Chicago

Tel.+1-847-545-6700
FAX. +1-847-545-6720
sales@us.sumida.com

Shanghai

Tel.+86-021-5836-3299
FAX.+86-021-5836-3266
shanghai.sales@cn.sumida.com

Seoul

Tel.+82-2-6237-0777
FAX.+82-2-6237-0778
sales@kr.sumida.com

Oberzell

Tel.+49-8591-937-0
FAX. +49-8591-937-103
contact@sumida-eu.com

Shenzhen

Tel.+86-755-8291-0228
FAX.+86-755-8291-0338
shenzhen.sales@cn.sumida.com

Singapore

Tel.+65-6296-3388
FAX.+65-6296-3390
sales@sg.sumida.com

Neumarkt

Tel.+49-9181-4509-110
FAX. +49-9181-4509-310
infocomp@eu.sumida.com

Taipei

Tel.+886-2-8751-2737
FAX.+886-2-8751-2738
sales@tw.sumida.com

San Jose

Tel.+1-408-321-9660
FAX.+1-408-321-9308
sales@us.sumida.com